

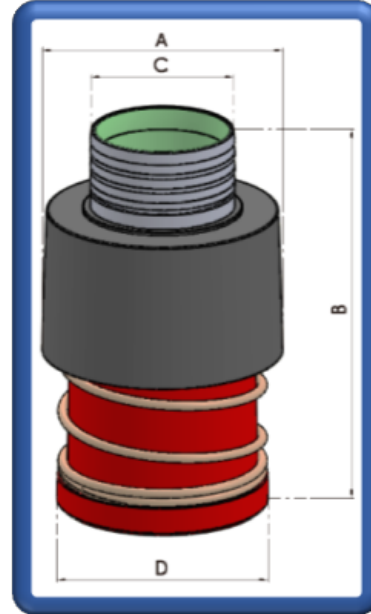

Quick-Fill

Male 2", Single Mount, Silver.
Part Number: RF-AA-005 (QMF251)



Specifications:

Fixing Arrangement:
Applications:
Compatibilities:
Finish:
Weight:
Supplied With:

N/A
Sports Car/ Motorcycle Racing & Endurance
Operation Temperature -40°C to +80°C
Anodised/ Natural
790.0 grams

Materials:

Flange:
Shut-off Sleeve:
O-Ring:
Springs:
Scraper:
Main shut-off sleeve & Spring Cover:
E-Clips:

Aluminium 6036/T1 Cast
Aluminium 6082/T6 Machined
Viton (FKM or FPM)
Stainless Steel EN43
PEEK
Nylon
Steel

Dimensions:

Outside Diameter A:
Depth B:
Spigot Diameter C:
Shut-Off Entry Diameter D:

95.0mm
160.0mm
57.0mm
83.2mm

Associated Parts:

Quick-Fill Handle
Overall Seal Kit

Fluid Containment – When It Matters

Tell: +4420 8594 7990 / Fax: +4420 8594 7989 / www.newton-equipment.com / info@newton-equipment.com
Registered in England. 6 Orwell Close/ Fairview Ind. Park/ Rainham/ Essex/ RM13 8UB