

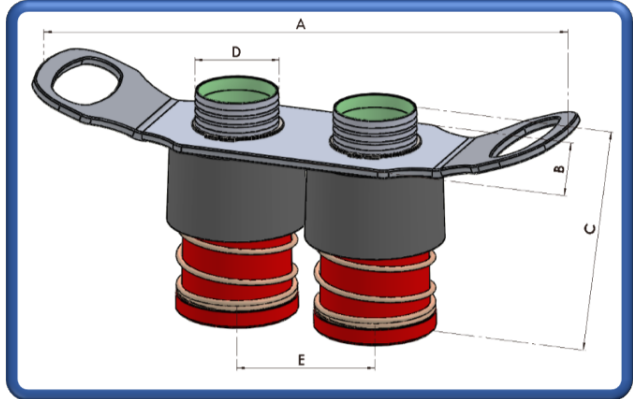

Quick-Fill

**Male 2", Twin Mount, Red/Black.
Part Number: RF-AA-006 (QMF252)**



Specifications:

Fixing Arrangement:

Applications:

Compatibilities:

Finish:

Weight:

Supplied With:

N/A

Sports Car/ Motorcycle Racing & Endurance

Operation Temperature -40°C to +80°C

Anodised/ Natural

2382.0 grams

Materials:

Flange:

Shut-off Sleeve:

O-Ring:

Springs:

Scraper:

Main shut-off sleeve & Spring Cover:

E-Clips:

Aluminium 6036/T1 Cast

Aluminium 6082/T6 Machined

Viton (FKM or FPM)

Stainless Steel EN43

PEEK

Nylon

Steel

Dimensions:

Length A:

Width B:

Depth C:

Spigot Diameter D:

Centre to Centre:

380.0 mm

100.0mm

160.0mm

57.0mm

100.0mm

Associated Parts:

Quick-Fill Handle

Overall Seal Kit

Fluid Containment – When It Matters

Tell: +4420 8594 7990 / Fax: +4420 8594 7989 / www.newton-equipment.com / info@newton-equipment.com

Registered in England. 6 Orwell Close/ Fairview Ind. Park/ Rainham/ Essex/ RM13 8UB